



DISCLAIMER
The United States Government furnishes this information for the general information of the recipient. The United States Government makes no warranty, expressed or implied, concerning the accuracy, completeness, or reliability of this information. The United States Government is not responsible for any errors or omissions in this information, or for any consequences arising from the use of this information. The recipient shall accept the information as it is provided and shall not rely on it for any purpose other than the intended purpose. The recipient shall release this information to other personnel only if the recipient has received the necessary authorization from the appropriate authority. The recipient shall not disseminate this information to other personnel without the necessary authorization from the appropriate authority.

Prepared Under the Direction of KEVIN P. ARNETT LT Colonel, C.E., District Engineer	Surveyed By: PDT	Chart Date: Sep 17, 2021
Submitted: Hydro Survey Team Leader	Plotted By: PDT	Designed by: PDT
Recommended: Chief, Hydro Survey Section	Checked By: PDT	Drawn by: PDT
Approved: Chief, Construction Branch		

SAN MATEO COUNTY
REWOOD CITY
REACH 1
POST-DREDGE SURVEY
16 SEPTEMBER 2021

Sheet Reference Number
1 of 4

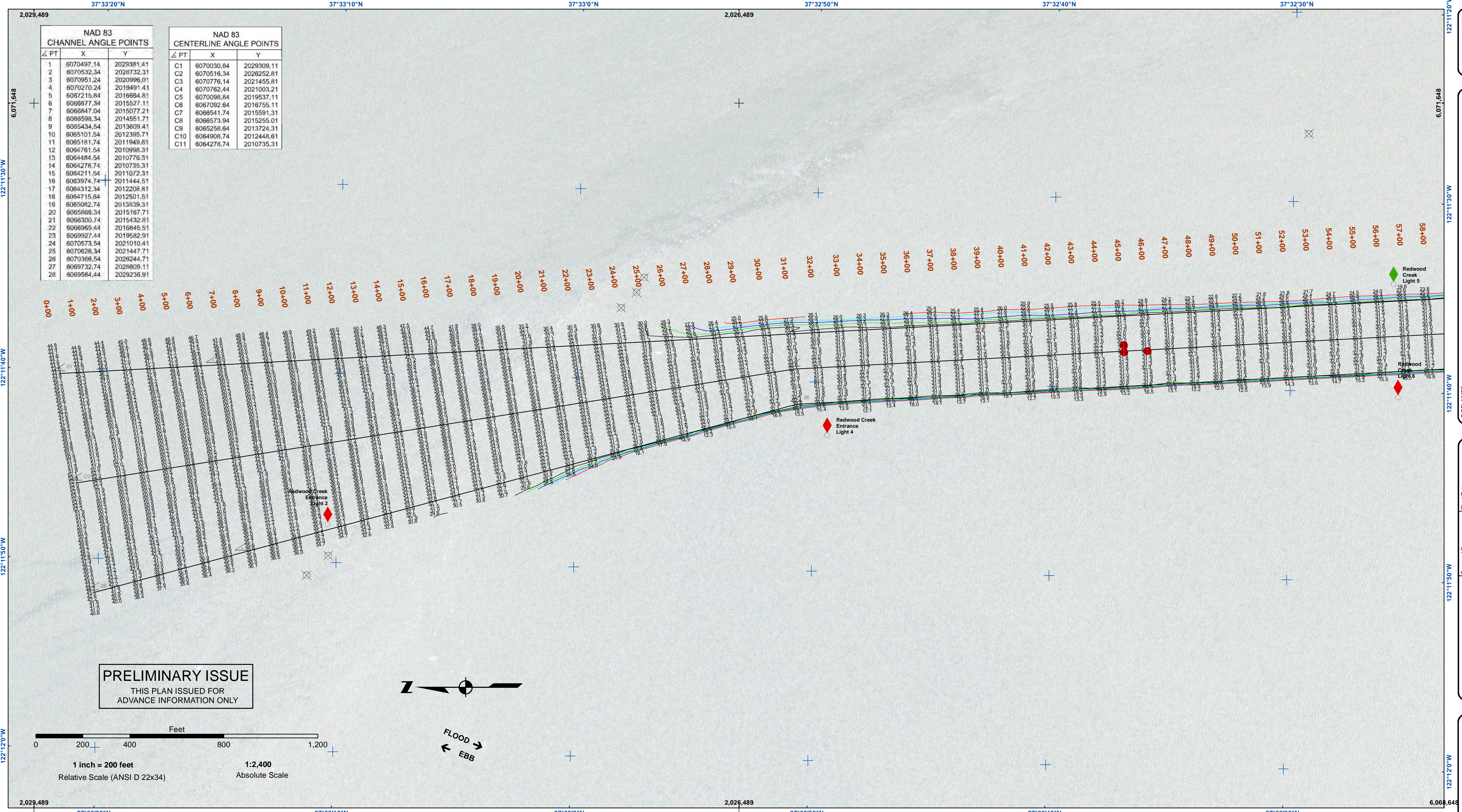

NAD 83 CHANNEL ANGLE POINTS		
PT	X	Y
1	6070497.14	2029381.41
2	6070532.34	2028732.31
3	6070951.24	2020996.01
4	6070270.24	2019491.41
5	6067215.84	2018684.81
6	6068677.34	2015527.11
7	6068847.04	2015077.21
8	6068598.34	2014551.71
9	6065434.54	2013809.41
10	6065101.54	2012395.71
11	6065181.74	2011949.61
12	6064781.54	2010998.31
13	6064484.54	2010776.31
14	6064278.74	2010735.31
15	6064211.54	2011072.31
16	6063974.74	2011444.51
17	6064312.34	2012208.81
18	6064715.84	2012501.51
19	6065082.74	2013839.31
20	6065886.34	2015167.71
21	6066300.74	2015432.81
22	6066969.44	2016845.51
23	6069927.44	2019582.91
24	6070573.54	2021010.41
25	6070628.34	2021447.71
26	6070366.54	2028244.71
27	6069732.74	2028609.11
28	6069564.44	2029236.91

NAD 83 CENTERLINE ANGLE POINTS		
PT	X	Y
C1	6070030.84	2029309.11
C2	6070516.34	2026252.81
C3	6070776.14	2021455.81
C4	6070762.44	2021003.21
C5	6070098.84	2019537.11
C6	6067092.64	2016755.11
C7	6066541.74	2015591.31
C8	6068573.84	2015255.01
C9	6065258.84	2013724.31
C10	6064908.74	2012448.61
C11	6064278.74	2010735.31

PRELIMINARY ISSUE
THIS PLAN ISSUED FOR
ADVANCE INFORMATION ONLY

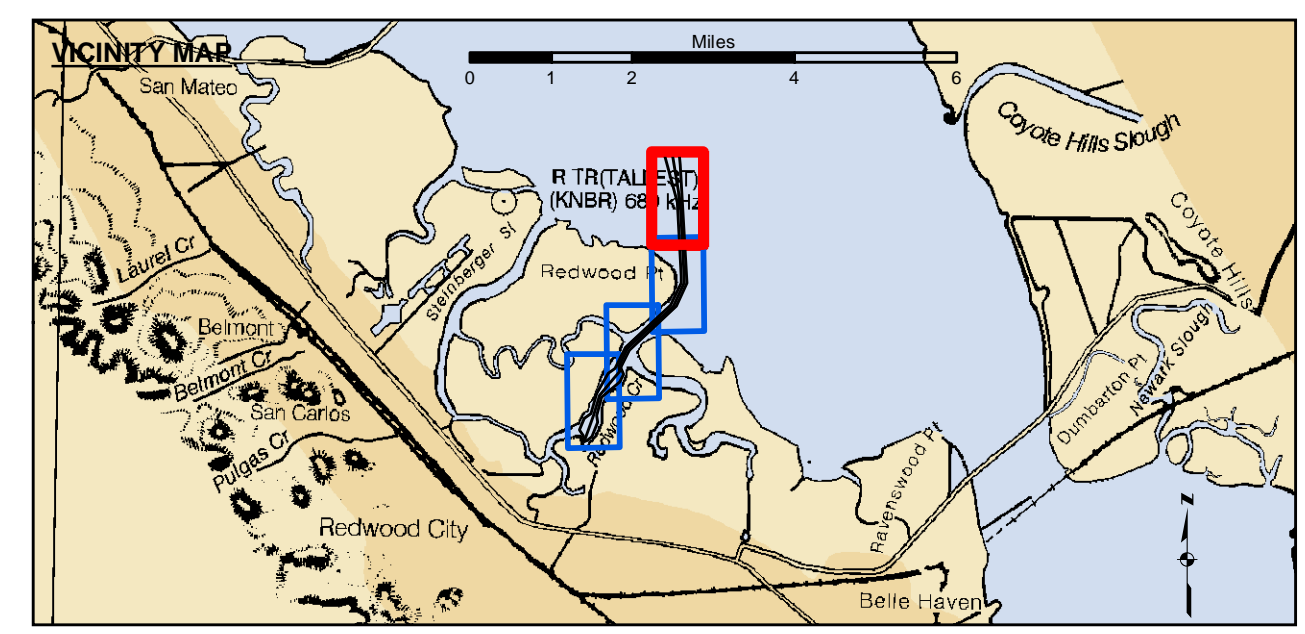
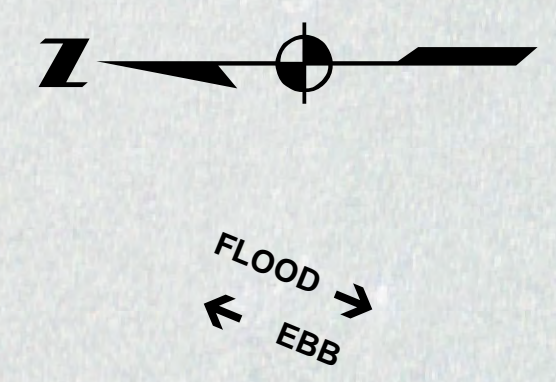
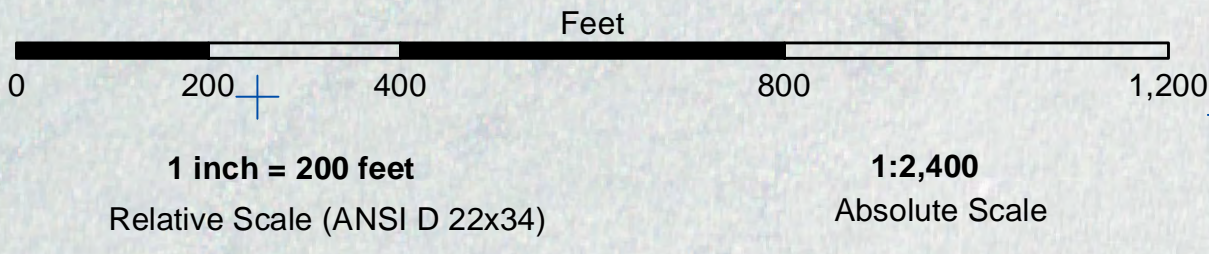

Federal Navigation Channel	Beacon, General	Contours
Shoaling Area	Obstruction Point	-30
Material Placement Area	Navigation Buoy	-29
Anchorage Area	Navigation Buoy	-28
Wreck Area	Shoalest Sounding*	-27
Submerged Wreck		-26
Angle Point		

NOTES:
DRAWING NOT TO BE USED FOR NAVIGATION. ONLY CHANNEL CONDITION AT DATE OF SURVEY.
THE LOCATION OF ALL NAVIGATION AIDS ARE BASED ON INFORMATION PROVIDED BY THE U.S. COAST GUARD. BUOY LOCATIONS REPRESENT THE POSITION OF THE SINKER ONLY.
INFORMATION DEPICTED ON THIS MAP REPRESENTS THE RESULTS OF SURVEYS MADE ON THE DATES INDICATED AND CAN ONLY BE CONSIDERED AS INDICATING THE GENERAL CONDITIONS AT THAT TIME.
SURVEYED BY THE CORPS OF ENGINEERS.
*SHOALEST SOUNDING PER QUARTER PER REACH

SOUNDINGS WERE TAKEN BY FATHOMETER AND ARE SHOWN TO THE NEAREST TENTH OF A FOOT. SOUNDINGS ARE BASED ON THE DATUM OF MEAN LOWER LOW WATER AT THE LOCALITY. BASE MAPS ARE USDA NAIP 2010.
PLANE GRID, BEARING AND COORDINATES ARE BASED ON THE STATE OF CALIFORNIA COORDINATE SYSTEM, LAMBERT CONFORMAL PROJECTION, ZONE III, CALIFORNIA, AS DESCRIBED IN SPECIAL PUBLICATION NO. 235, PUBLISHED BY NATIONAL OCEAN SURVEY.
THE PROJECT DEPTH IS 30 FEET AT M.L.L.W.
SOUNDINGS ARE BASED ON THE TIDE GAUGE LOCATED AT RAZ 6 & RAZ 5
LINES 18+00 TO 100+00 @ BEACON NO. 8
LINES 101+00 TO 160+00 @ RAZ 6
LINES 160+ TO 208+49 @ RAZ 5
VERTICAL CONTROL:
BENCHMARK, MLLW ELEV., AGENCY
BM 4501 A, NOS TIDAL DISK, 12.15 MLLW
BM 4508 U 1998, NOS TIDAL DISK, 11.88 MLLW
BM 13 1974, NOS TIDAL DISK, 12.99 MLLW
HORIZONTAL CONTROL:
DESIGNATION, SOURCE, XYZ
COAST GUARD D-BEACON.

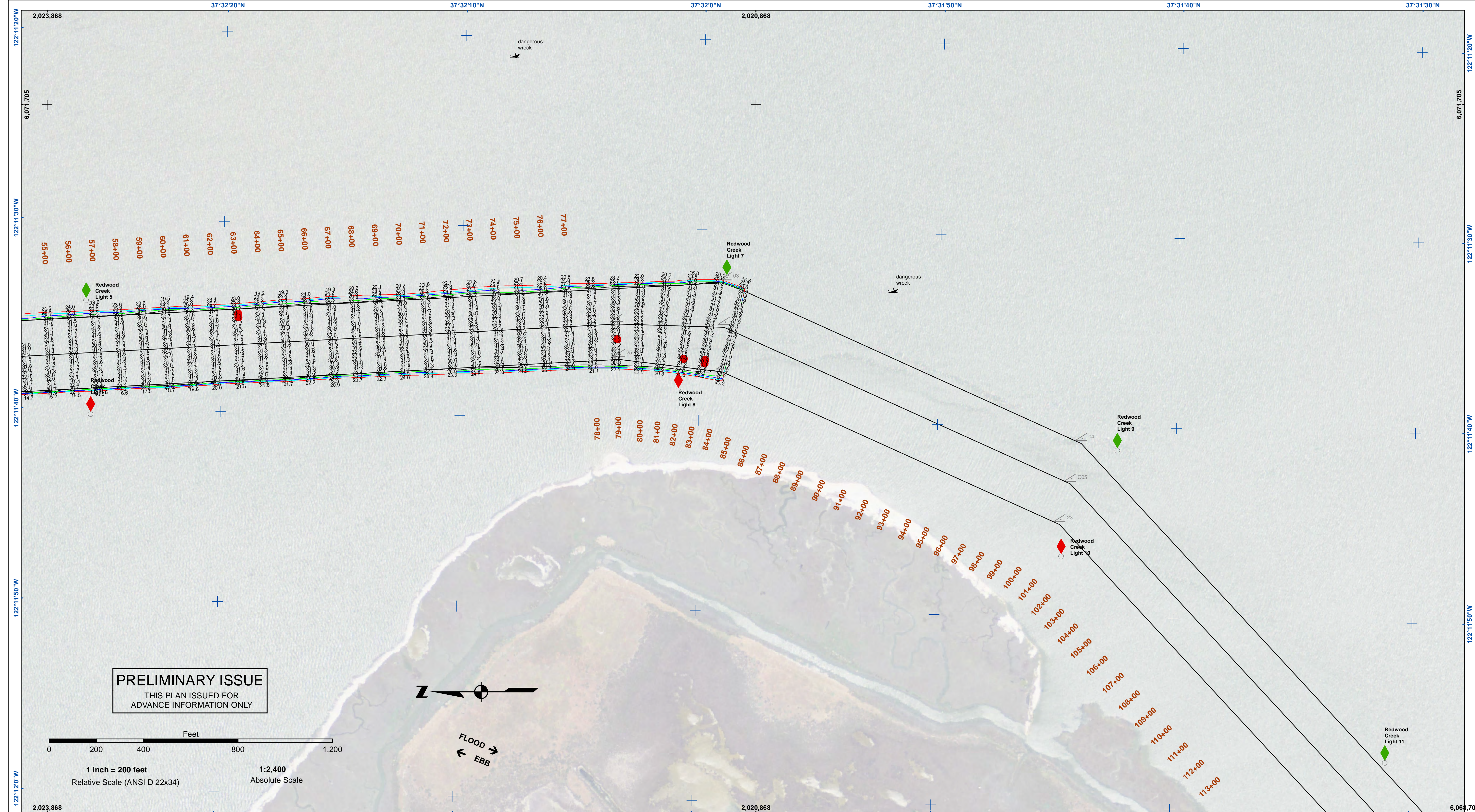

PRELIMINARY ISSUE
THIS PLAN ISSUED FOR
ADVANCE INFORMATION ONLY

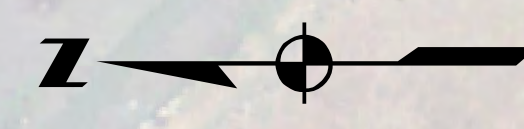

FLOOD →
← EBB

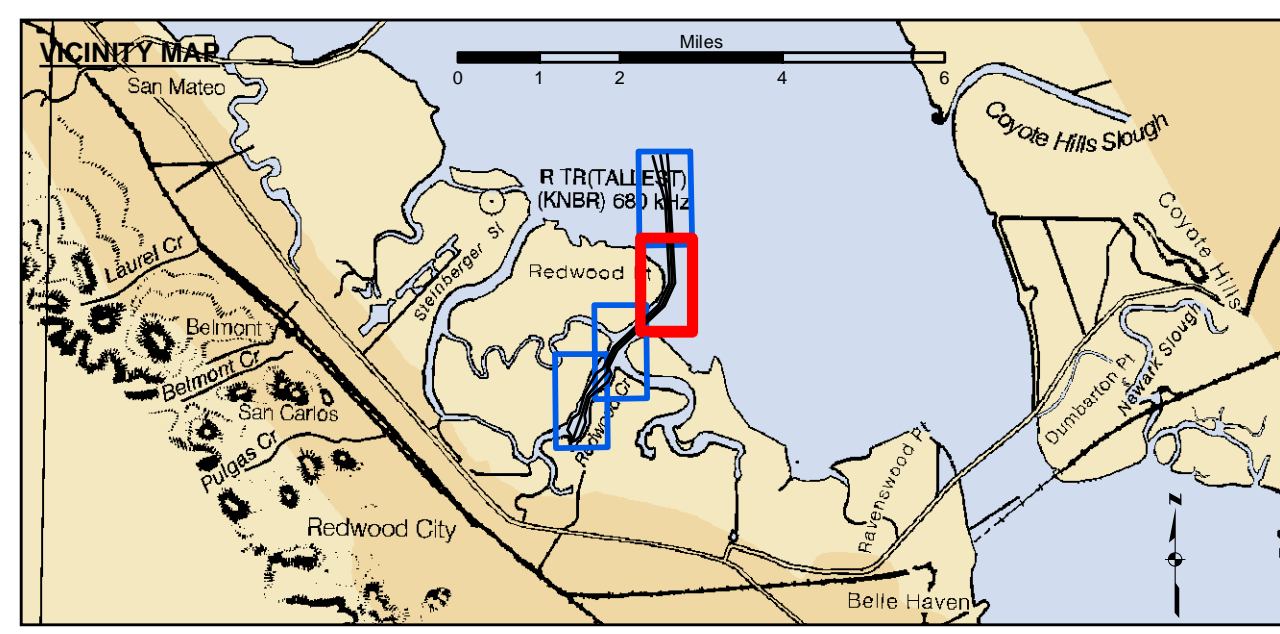

	Federal Navigation Channel		Beacon, General	Contours	
	Shoaling Area		Obstruction Point		
	Material Placement Area		Navigation Buoy		
	Anchorage Area		Navigation Buoy		
	Wreck Area		Shoalest Sounding*		
	Submerged Wreck				-30
	Angle Point				-29
					-28
					-27
					-26

NOTES:
DRAWING NOT TO BE USED FOR NAVIGATION. ONLY CHANNEL CONDITION AT DATE OF SURVEY.
SOUNDINGS ARE BASED ON THE DATUM OF MEAN LOWER LOW WATER AT THE LOCALITY.
BASE MAPS ARE USDA NAIP 2010.
PLANE GRID, BEARING AND COORDINATES ARE BASED ON THE STATE OF CALIFORNIA COORDINATE SYSTEM, LAMBERT CONFORMAL PROJECTION, ZONE III, CALIFORNIA, AS DESCRIBED IN SPECIAL PUBLICATION NO. 235, PUBLISHED BY NATIONAL OCEAN SURVEY.
THE PROJECT DEPTH IS 30 FEET AT M.L.L.W.
SOUNDINGS ARE BASED ON THE TIDE GAUGE LOCATED AT RAZ 6 & RAZ 5
LINES 18+00 TO 109+00 @ BEACON NO. 8
LINES 101+00 TO 169+00 @ RAZ 6
LINES 160+ TO 208+49 @ RAZ 5
VERTICAL CONTROL:
BENCHMARK, MLLW ELEV., AGENCY
BM 4501 A, NOS TIDAL DISK, 12.15 MLLW
BM 4508 U 1998, NOS TIDAL DISK, 11.88 MLLW
BM 13 1974, NOS TIDAL DISK, 12.99 MLLW
HORIZONTAL CONTROL:
DESIGNATION, SOURCE, XYZ
COAST GUARD D-BEACON.

INFORMATION DEPICTED ON THIS MAP REPRESENTS THE RESULTS OF SURVEYS MADE ON THE DATES INDICATED AND CAN ONLY BE CONSIDERED AS INDICATING THE GENERAL CONDITIONS AT THAT TIME.
SURVEYED BY THE CORPS OF ENGINEERS.
*SHOALEST SOUNDING PER QUARTER PER REACH



DISCLAIMER
The United States Government furnishes this information as a public service. It is not intended to be used for any purpose other than the intended purpose. The user is responsible for the results of any application of the data for other than the intended purpose. The user is responsible for the results of any application of the data for other than the intended purpose. The user is responsible for the results of any application of the data for other than the intended purpose.

Chart Date:	Sep 17, 2021
Designed by:	PDT
Plotted by:	PDT
Checked by:	PDT
Drawn by:	PDT

SAN MATEO COUNTY
REWOOD CITY
REACH 1
POST-DREDGE SURVEY
16 SEPTEMBER 2021

Sheet Reference Number
2 of 4